

# Perry het vogelbekdier

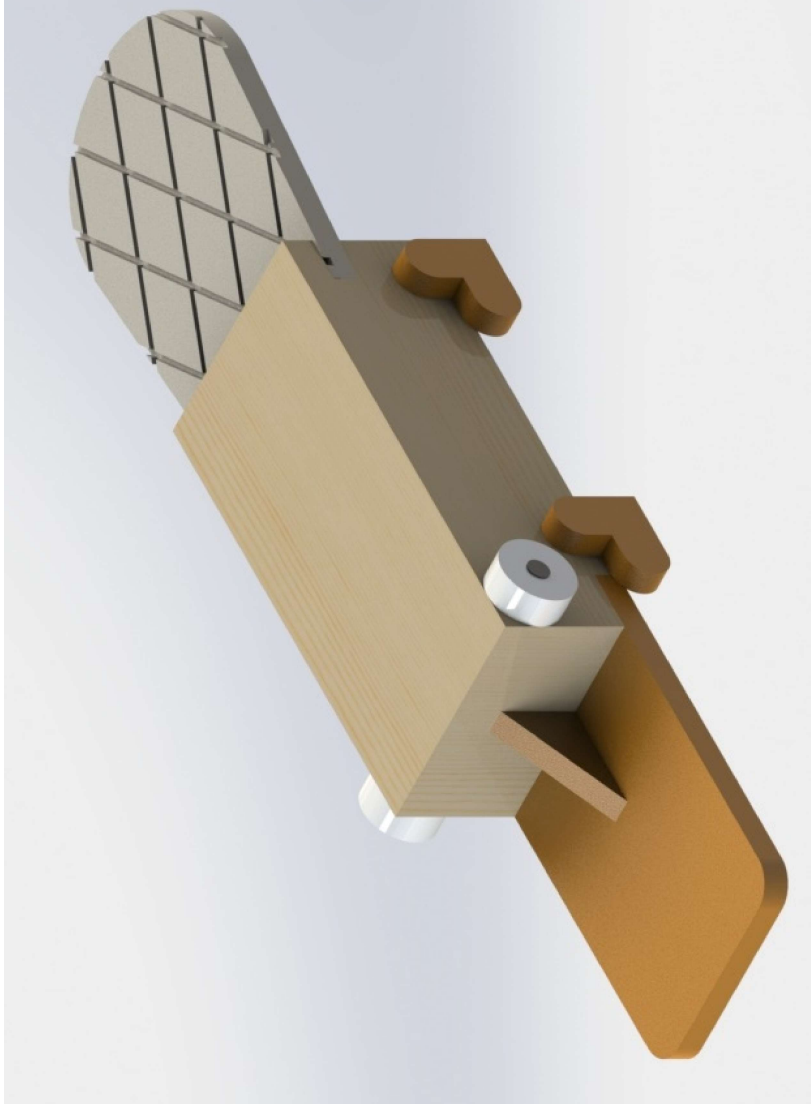

# Onderdelen van Perry

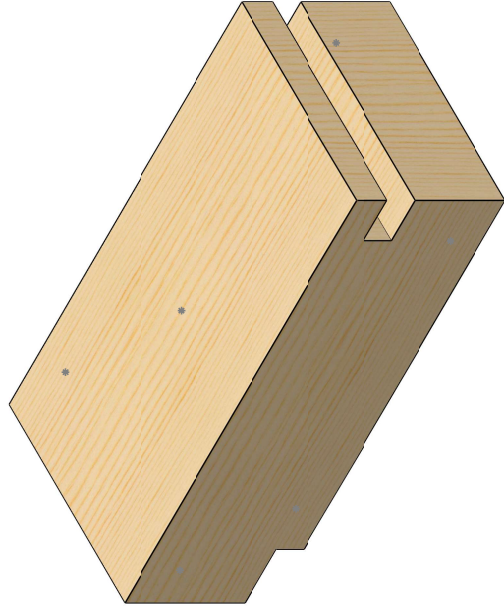

1 (lijf) Houten balk  
15 x 7,5 x 5

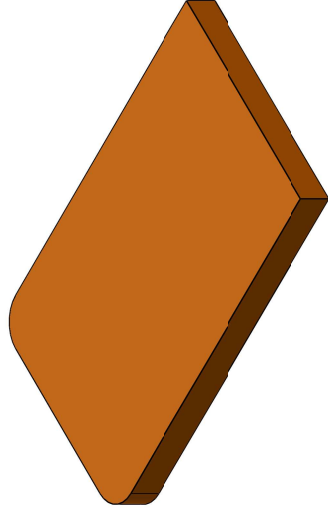

2 (tong) MDF 9mm  
12 x 7,5

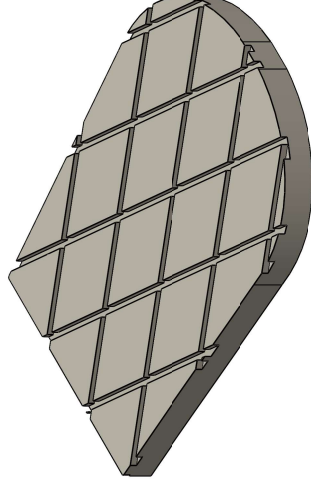

3 (staart) MDF 9mm  
12 x 9

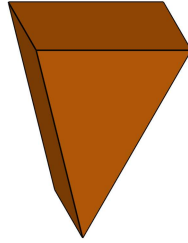

4 (steun) MDF 9mm  
3,5 x 2,5

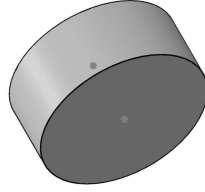

5 (oog) 2,5 x 1

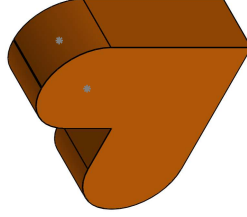

6 (poot) MDF 9mm  
3,5 x 3,5

1

# Het lijf op maat maken 1

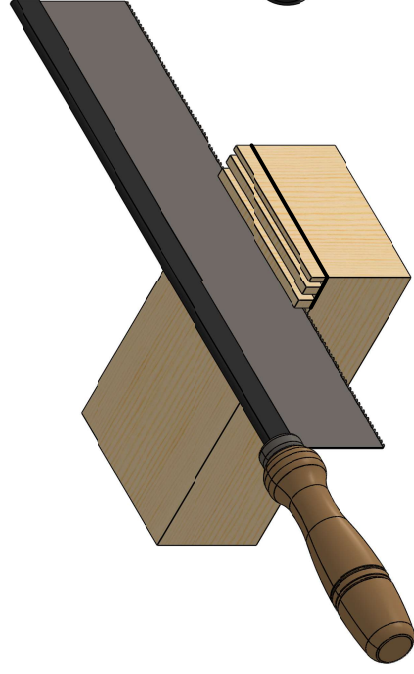
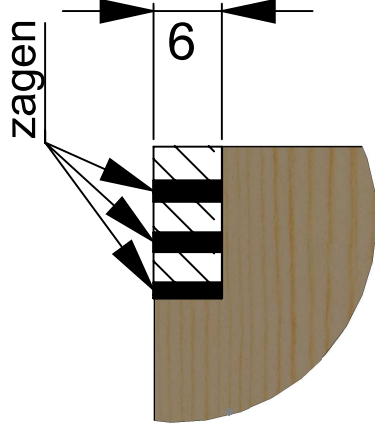
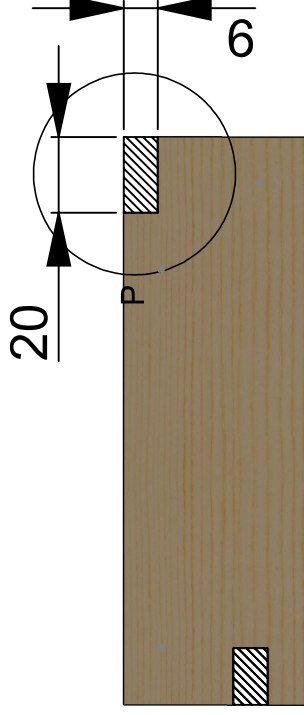

3x inzagen

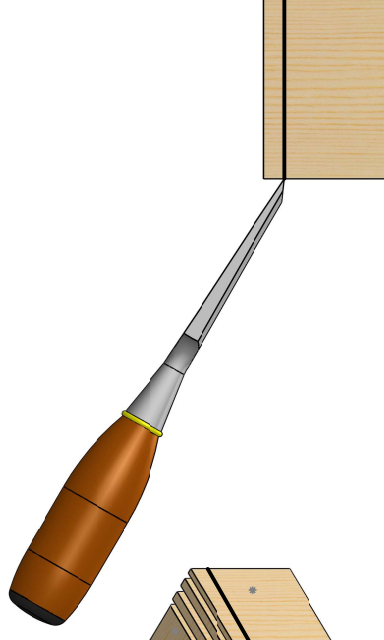
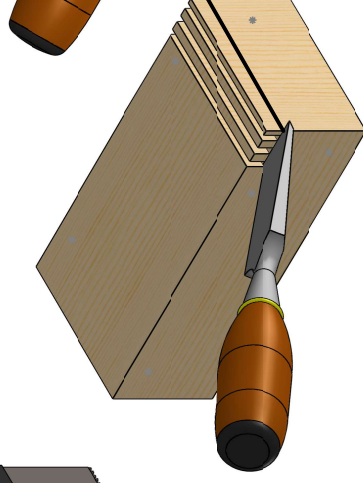

voorzichtig met een  
houtbeitel restant  
weghakken

2

# Het lijf op maat maken 2

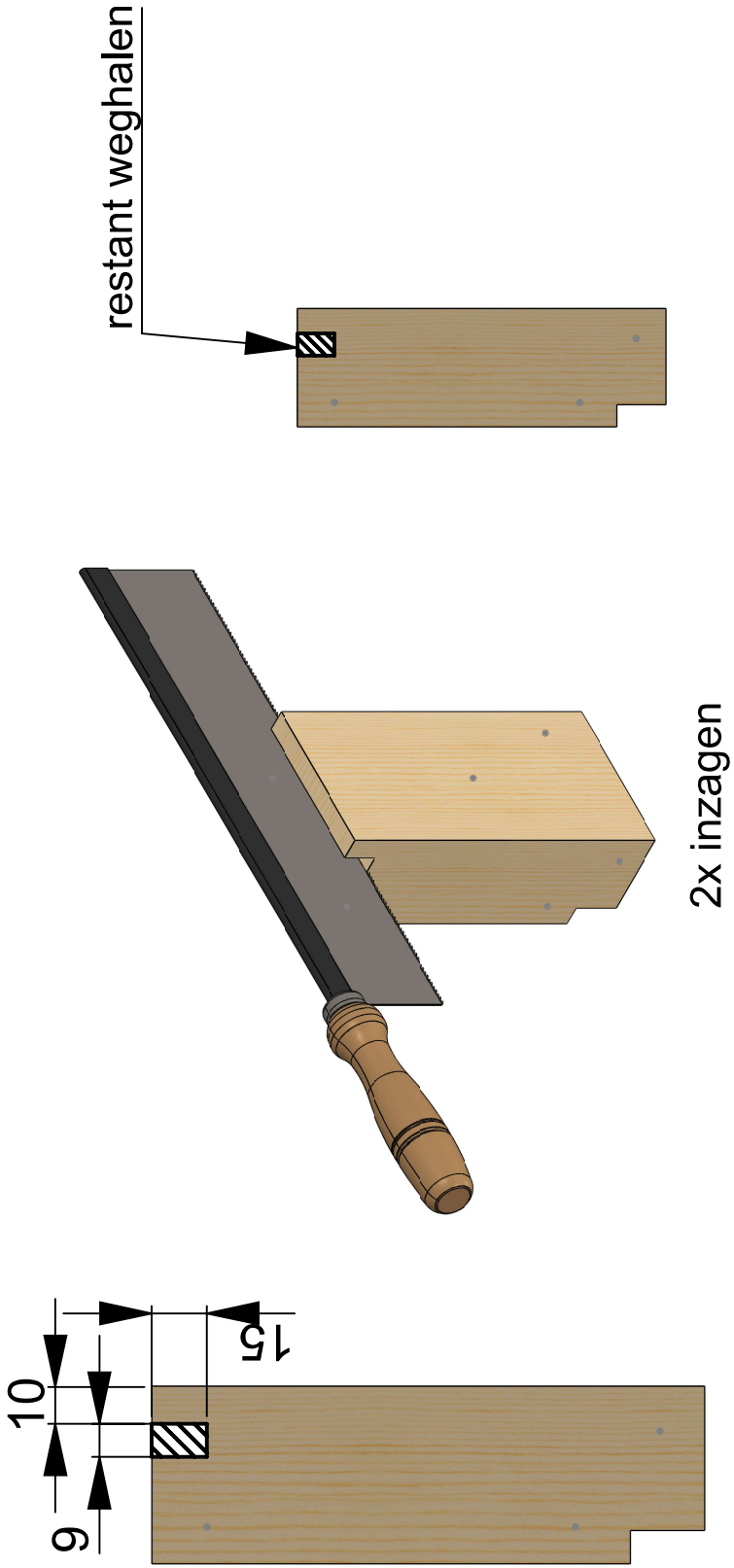

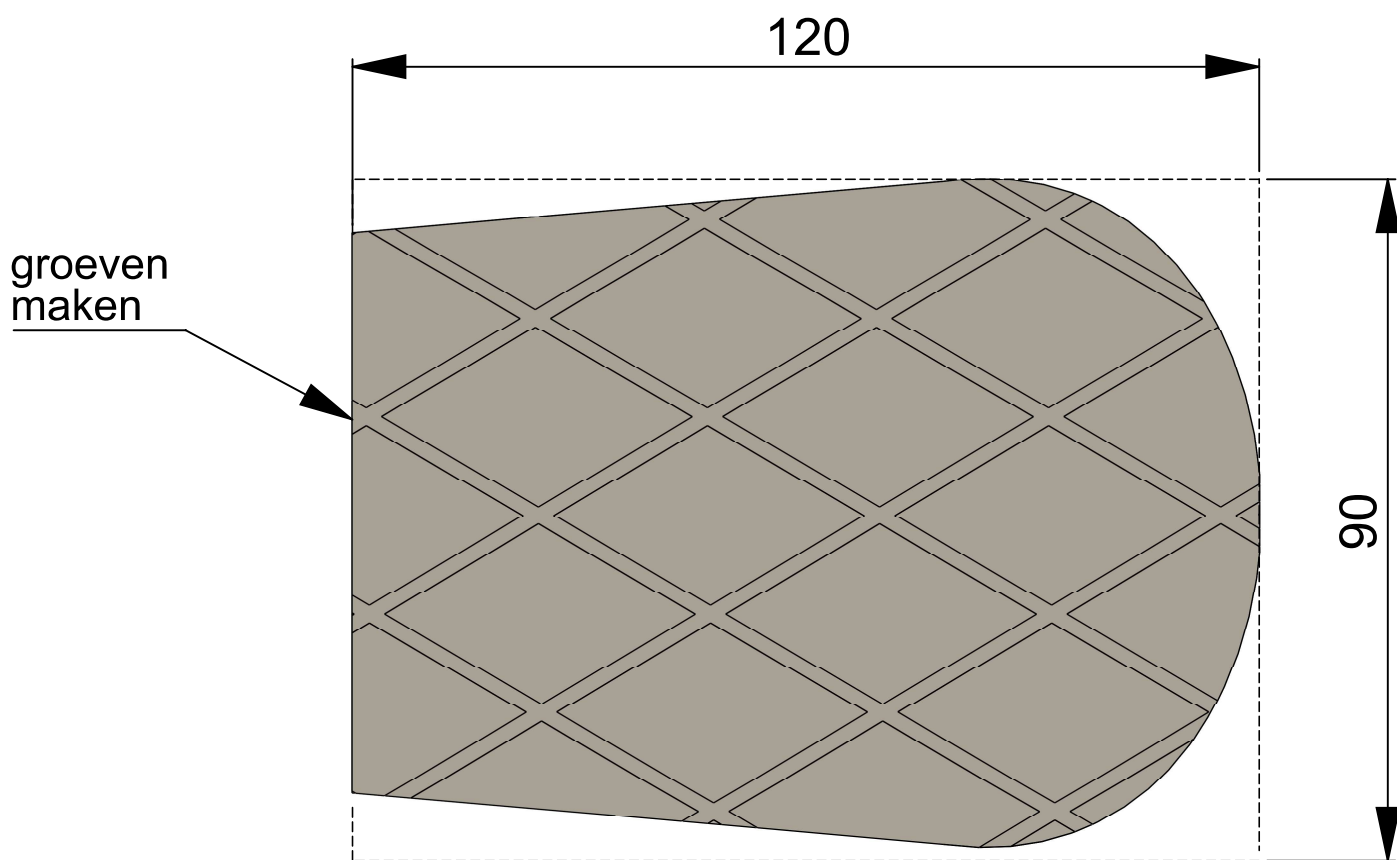
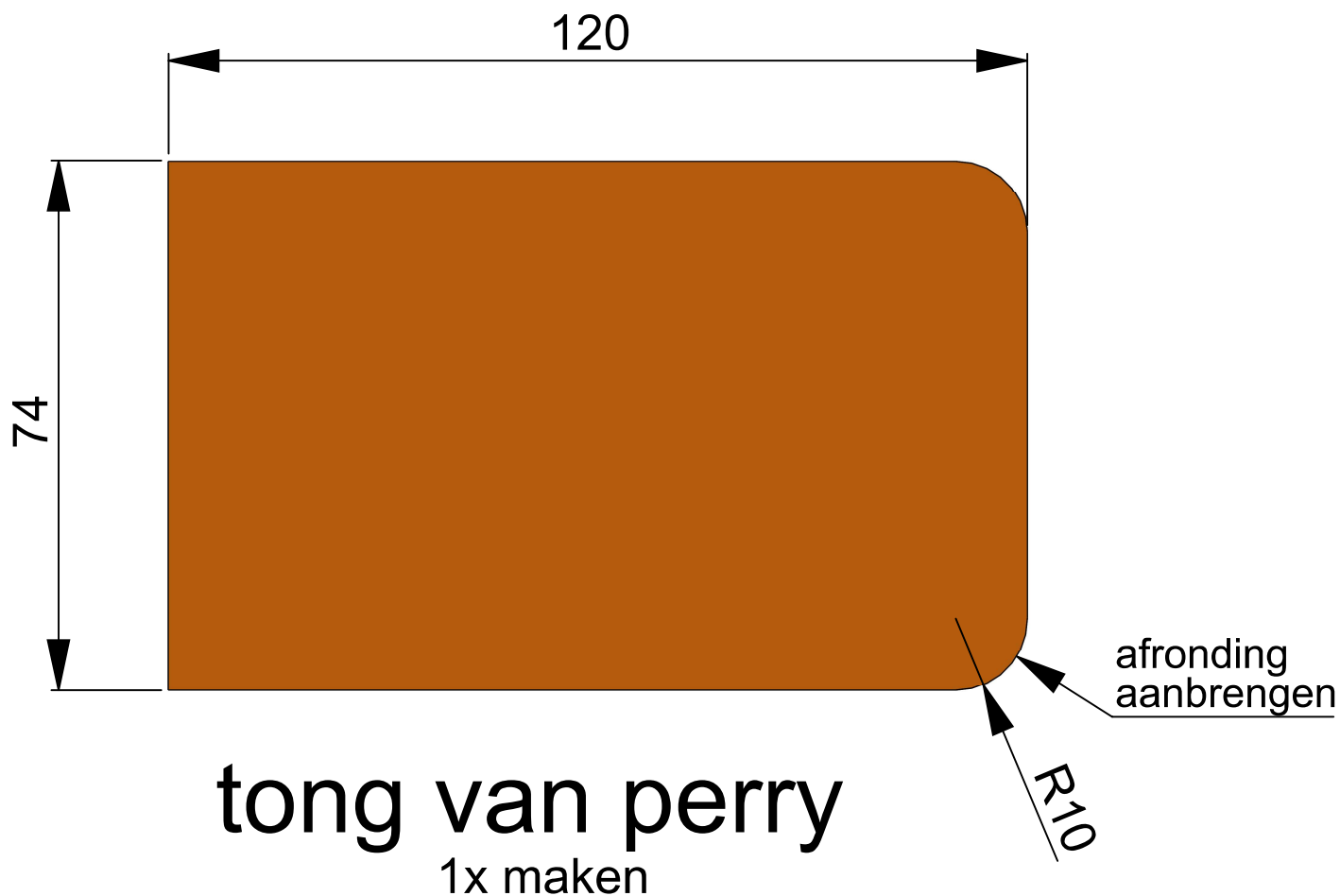

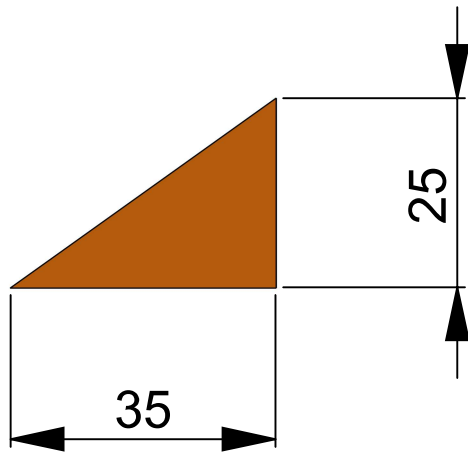

1x maken

tongsteun  
van perry

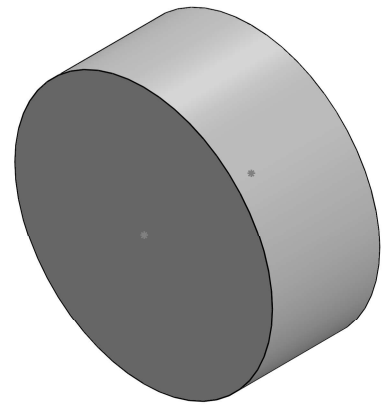

2x maken

oog  
van perry

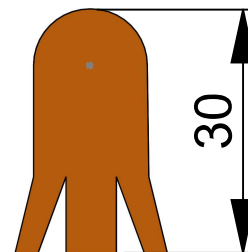
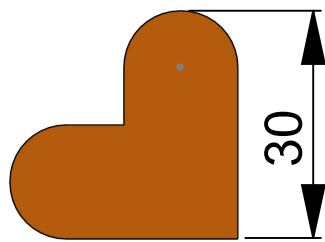

maak zelf 4 poten  
voor perry

poot van perry

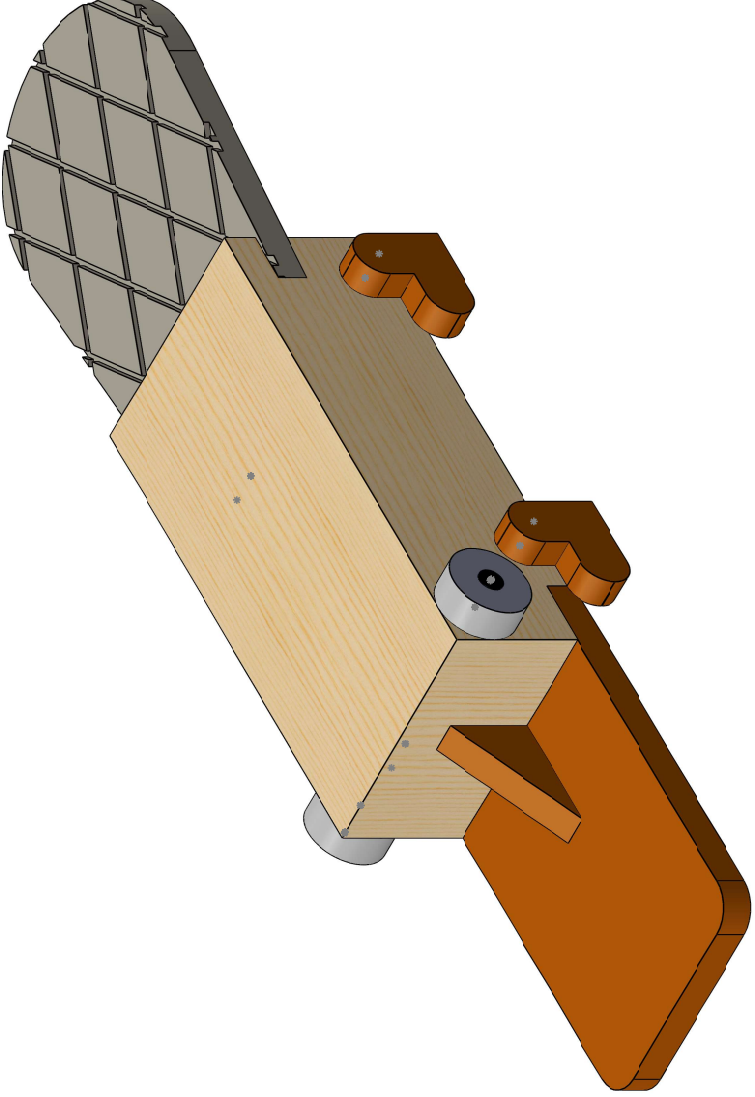

perry in elkaar lijmen  
en versieren

6